



Comfort Where It Counts.

CNR CORNER MOUNTED AIR HANDLER

P/N# 240-4004, Rev. 1.5 [11/04]

SPECIFICATIONS AND PERFORMANCE



STRAIGHT COOL/HEAT PUMP

Nominal Capacities: 9,000 and 12,000 Btuh

PRODUCT DESCRIPTION

EMI's corner mounted air handler (CNR) is revolutionary in its state-of-the-art design as a ductless evaporator that can be mounted inconspicuously in the corner of most any room. Using mounting holes on the unit that are set up to align with any wall construction (including walls with non-square corners), the CNR utilizes previously unused wall space for effective high efficiency room conditioning with whisper quiet operation.

The CNR is equipped with unit mounted infrared compatible controls and offers ease of installation (supplied positioning bracket allows the CNR to be installed by one person if necessary), operation, and service for small to midsize commercial or residential spaces. The CNR can be matched with EMI's Single Zone (SCC/SHC) or Multi-Zone (MC2/MH2 and MC4/MH4) condenser units. Heat pump models provide up to a nominal 12,000 Btuh of cooling/heating and a 3kw electric heat option is available. Other design features include dual supply air flow and versatility of tubing and wiring access through multiple entrances on the unit.

The CNR is backed by Enviromaster International LLC and is tested and rated in accordance with ARI Standard 210/240 and UL1995.

AIR HANDLER STANDARD FEATURES

▲▼ **Materials of Construction:**

- Cabinet fabricated of 20-gauge galvalneal steel with an off-white powder coat matte finish
- Discharge grill constructed of high temperature Noryl plastic
- Condensate drain pan constructed of anti-corrosive G90U galvanized steel

▲▼ **Controls and Components - factory installed or supplied:**

- Relays/connections for condensing unit
- Low Volt transformer
- Positioning bracket, templates, and mounting hardware
- Unit mount control panel
 - 3/4" backlit LCD display
 - Adjustable operational range from 55°F to 95°F (in one-degree increments)
 - Anti-short cycle compressor protection
 - Minimum compressor run time
 - 60 second fan purge
 - Freeze protection
 - Audio feedback on control setting changes
 - Universal control board for straight cool or heat pump condenser operation
 - Two-stage heating w/optional electric heat and heat pump condenser
 - Fan operation: Auto (cycling), high and low (constant)
 - Dry mode (operates cooling and electric heat simultaneously to remove humidity when optional electric heat is selected)
 - Test operation for ease of testing after installation (all timers eliminated)
 - Non-volatile backup memory (control settings maintained indefinitely during power outages)

IMPORTANT: *Unit mounted controls are fully functional without the remote.*

OPTIONAL EQUIPMENT

- Integral condensate pump (field installed)
- Hand held infrared controller
- Wall mounted thermostat control
- 3KW electric heat with automatic reset high temperature cutout and redundant high temperature fuse link
- Top trim kit for finished look between unit and ceiling

INSTALLER SUPPLIED ITEMS

- Low Voltage wiring (18 awg recommended)
- Power wiring
- 5/16" wall anchors (if needed)
- 1/2" I.D. condensate piping
- Refrigerant (for interconnect charge)
- Refrigerant piping (if not supplied)

CNR DIMENSIONS AND SPECIFICATIONS

NOTE: Due to ongoing development programs, design and specifications may change without notice.

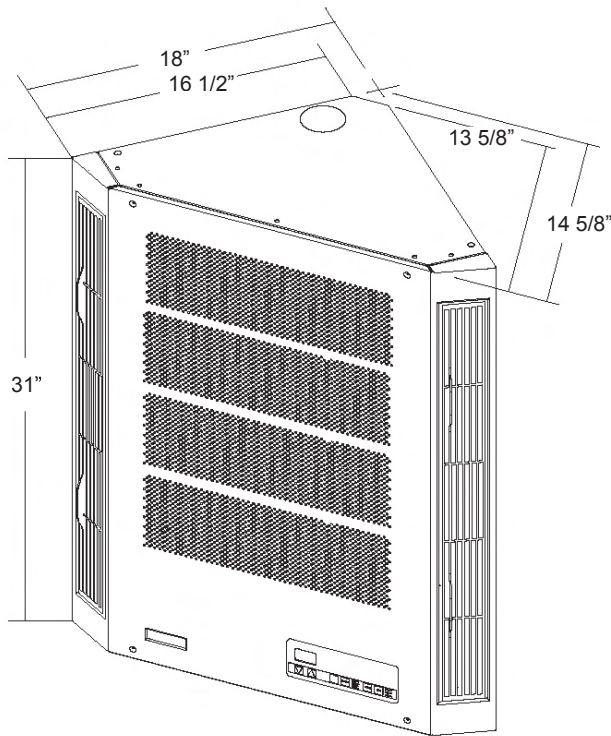

Shipping Weight = 70 Pounds

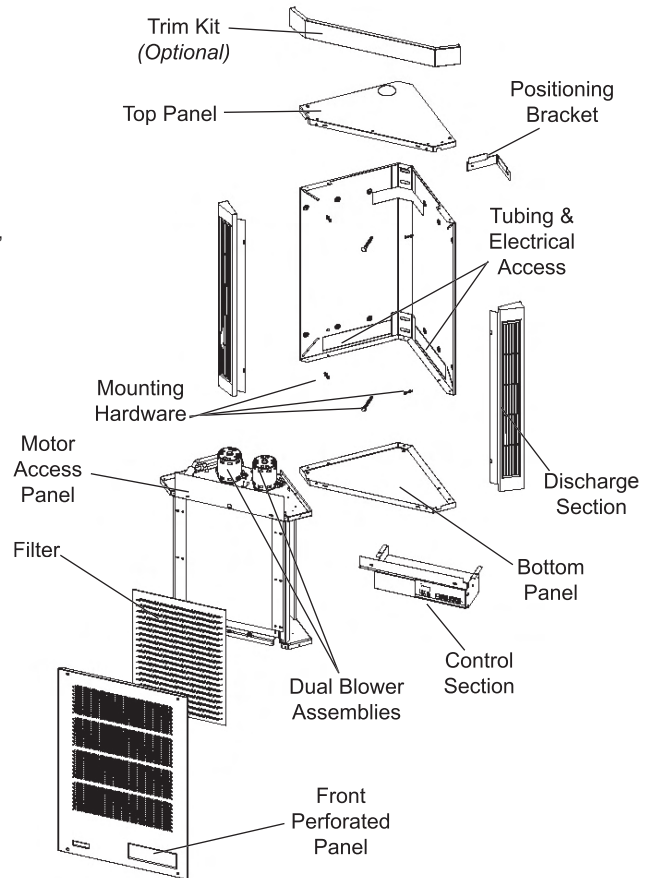

CNR ELECTRICAL SPECIFICATIONS										
MODEL	VOLTS/HZ/PH	ELECTRIC HEAT		INDOOR FAN#1		INDOOR FAN#2		TOTAL AMPS	MCA	MAX FUSE
		WATTS	AMPS	H.P.	FLA	H.P.	FLA			
WITH ELECTRIC HEAT	115/60/1	750	6.52	0.02	0.6	0.02	0.6	7.7	9.6	15
	208-230/60/1	3000	13.04	0.02	0.34	0.02	0.34	13.7	17.1	20
WITHOUT ELECTRIC HEAT	115/60/1	N/A	N/A	0.02	0.6	0.02	0.6	1.2	1.4	15
	208-230/60/1	N/A	N/A	0.02	0.34	0.02	0.34	0.7	0.8	15

COIL	CNR DISCHARGE AIR SPEED AND FLOW					
	CFM		FPM		THROW/FT.	
	LOW	HIGH	LOW	HIGH	LOW	HIGH
DRY	335	370	700	750	10	12

INTERCONNECTING REFRIGERANT LINE SIZES	
LIQUID	SUCTION
1/4"	1/2"

CNR SOUND VALUES	
LOW	HIGH
48 dbA	49 dbA



EMI
Comfort Where It Counts.

ENVIROMASTER INTERNATIONAL LLC
5780 Success Drive, Rome, NY 13440
Phone: 1-800-228-9364
FAX: 1-800-232-9364