

RetroAire VPRC/VPRH Single Packaged Vertical Unit R-410A Refrigerant



NEW!

RETROAIRE
The right fit for comfort

VPRC/VPRH
Single Package Vertical Unit

- Straight Cool/Heat Pump with Electric or Hydronic Heat
- R-410A Certified Efficiency
- 9,000 – 36,000 Btuh (2.8 – 10.5 kW)

RetroAire's new Vertical Packaged Unit, VPRC/VPRH is an economical means to provide cooling and heating. Proudly made in the United States of America, seven capacity sizes are available in both a cooling only (VPRC) and heat pump (VPRH) versions. RetroAire's Vertical Packaged Unit is installed in a closet which allows for ducting to adjacent rooms for maximum comfort at minimal expense. Ideally suited for hotel/motel, extended care and assisted living facilities, apartments and dormitories, the VPRC/VPRH allows for design flexibility to meet many applications.

Versatility
Offered with many factory installed options, the VPRC/VPRH can be tailored for many applications. With optional control box locations, disconnect switches, duct collars, electric or hydronic heat, and coil corrosion protection, these units are some of the most versatile units on the market. Field-installed custom wall sleeves minimize space intrusion, leading to more valuable living space. Together with Return Air Access Panels the VPRC/VPRH provides a complete package.

Environmental Protection
RetroAire's VPRC/VPRH units use R-410A, a hydrofluorocarbon refrigerant blend. R-410A complies with the Montreal Protocol and does not have a scheduled phase-out date.
All VPRC/VPRH units meet the ASHRAE 90.1-2007 Efficiency Standards, with cooling efficiencies as high as 3.2 as 10.3 EER and heating efficiencies as high as 3.2 COP. All units are ARI Performance Certified to ARI-390 insuring their performance.
Low sound levels are inherent with the vertical terminal units. With insulation for thermal performance, lower sound levels are an added benefit.

A Vertical Stack Packaged Unit that maximizes comfort with minimal expense

- Hotel/Motel
- Extended Care Facilities
- Apartments
- Dormitories



VPRC/VPRH

Single Packaged Vertical Unit

Introduction

In the mid-1990's, RetroAire introduced the Vertical Packaged Unit, then known as a Vertical Packaged Terminal Unit to the market when Motel 6 approached RetroAire for a special air conditioning unit.

Since then, this American-made product has been meeting the needs of many customers.

Produced with pride in our Central New York facility, the RetroAire Vertical Packaged Units offer a number of options to meet most applications.

RETROAIRE
The Right Fit for Comfort



 **ecr**
innovative living™

VPRC/VPRH

Single Packaged Vertical Unit

R-410A Refrigerant

R-410A is an Azeotropic Blend of 50% HFC-32 and 50% HFC-125.

Factory Charged with R-410A.

R-410A is a refrigerant without a phase-out date in the Montreal Protocol.

R-410A Ozone Depletion Factor is 0.

An Environmentally Responsible Decision

RETROAIRE
The Right Fit for Comfort



HFC-32
Difluoromethane
 CH_2F_2

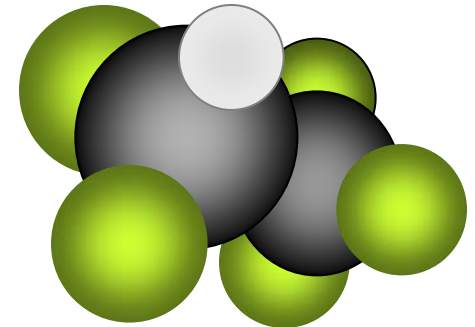

HFC-125
Pentafluoromethane
 CF_3CHF_2

VPRC/VPRH

Single Packaged Vertical Unit

Efficiency

Starting January 1, 2010, new efficiency standards take effect. ASHRAE 90.1-2004 efficiency standards for the Vertical Packaged Units of 9.0 EER and 3.0 COP are required.

An Environmentally Responsible Decision

RETROAIRE
The Right Fit for Comfort

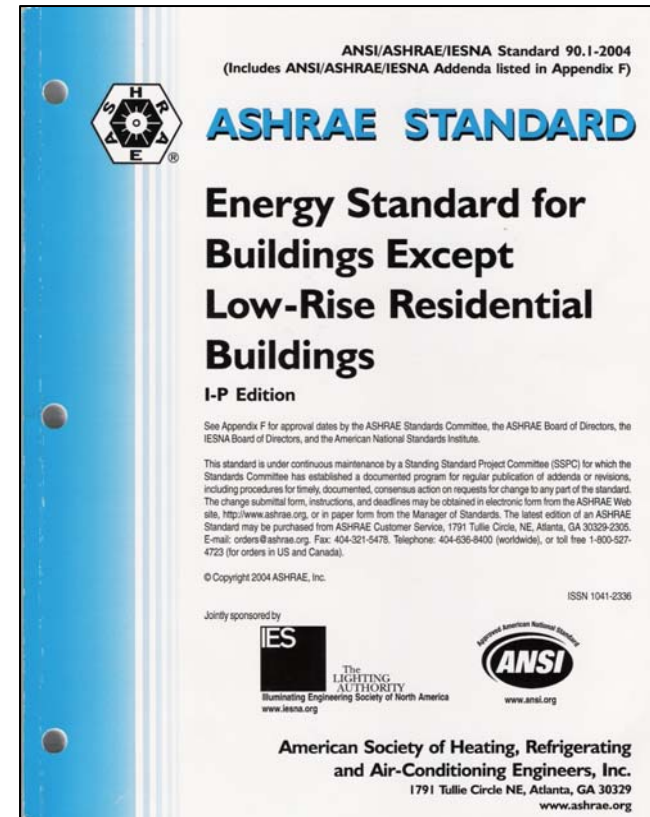

Minimum Cooling Efficiency = 9.0 EER
Minimum Heating Efficiency = 3.0 COP



VPRC/VPRH

Single Packaged Vertical Unit

RETROAIRE
The Right Fit for Comfort

Straight Cool - VPRC

Seven capacity sizes cover the range from 9,000 to 36,000 Btuh (2.8 to 10.5 kW)

Supplemental electric or hydronic heat is available.

Unit	Cooling		Heating	
	Capacity Btuh (kW)	EER	Capacity Btuh (kW)	COP
VPRC09	9,000	9.0	N/A	N/A
VPRC12	12,000	9.0	N/A	N/A
VPRC18	17,200	9.0	N/A	N/A
VPRC19	18,400	9.0	N/A	N/A
VPRC24	23,200	9.0	N/A	N/A
VPRC30	31,600	9.0	N/A	N/A
VPRC36	35,600	9.0	N/A	N/A

Versatility



 **ecr**
innovative living™

VPRC/VPRH

Single Packaged Vertical Unit

RETROAIRE
The Right Fit for Comfort

Limited Range Heat Pump - VPRH

Seven capacity sizes cover the range from 9,000 to 36,000 Btuh (2.8 to 10.5 kW)

Supplemental electric or hydronic heat is available.

Emergency Supplemental Heat is available with a 2-stage thermostat.

Unit	Cooling		Heating	
	Capacity Btuh (kW)	EER	Capacity Btuh (kW)	COP
VPRH09	9,000	9.0	9,000	3.0
VPRH12	12,000	9.0	11,400	3.0
VPRH18	17,200	9.0	16,200	3.0
VPRH19	18,400	9.0	16,400	3.0
VPRH24	23,200	9.0	21,600	3.0
VPRH30	31,600	9.0	32,000	3.0
VPRH36	35,600	9.0	36,000	3.0

Versatility



 **ecr**
innovative living™

VPRC/VPRH

Single Packaged Vertical Unit

Certified Performance

RetroAire VPRC/VPRH units follow in the footsteps of its predecessors the VPAC/VPHP being Performance Certified to ARI 390.

An independent test laboratory tests and compares the results to the published ratings.

Certified ratings are available on the Air Conditioning, Heating, and Refrigeration Website, www.ahrinet.org.

Certification assures the unit performance meets the published ratings.

Specify and look for the Certification Mark. RetroAire is the only Certified R-410A unit available on the market!

Value

RETROAIRE
The Right Fit for Comfort

The screenshot shows the AHRI website's "Directory of Certified Product Performance" page. The AHRI logo is at the top left, with the text "Air-Conditioning, Heating, and Refrigeration Institute". The main heading is "Directory of Certified Product Performance". Below this, a sub-heading reads "The AHRI Certification Programs are the trusted sources of performance for heating, ventilation, air-conditioning, and commercial refrigeration equipment." There are two main sections: "RESIDENTIAL" and "COMMERCIAL", each with a list of product categories. The "RESIDENTIAL" list includes: Air Conditioners and Air Conditioner Coils, Baseboard Radiation, Boilers, Direct Geo Exchange Heat Pumps, and Direct Heaters. The "COMMERCIAL" list includes: Liquid-to-Liquid Heat Exchangers, Non-Condensable Gas Purge Equipment, Packaged Terminal Air Conditioners, Packaged Terminal Heat Pumps, Refrigerant & Recovery, Room Fan-Coil Air Conditioners, Single Package Vertical Systems, Transport Refrigeration Units, and Utility Loss Equipment. To the right, there are logos for "TRUSTED MARKS OF PERFORMANCE ASSURANCE" including AHRI Performance Certified, I-B-R, and Energy Rating Certified Gama. Below these logos is a link "Are you a Manufacturer? | Sign In" and a "Resources" section with links to find ENERGY STAR Qualified Air Conditioning and Heat Pump Systems, Find Standards, Learn more about Certification Programs, Find NATE-certified HVACR contractors, and Help with this site. At the bottom, there is a copyright notice: "Copyright © 2008 Air-Conditioning, Heating, & Refrigeration Institute | Home | Terms and Conditions | License Data | Disclaimer".



VPRC/VPRH

Single Packaged Vertical Unit

Quiet Operation - Indoors

Inherent with the closet application, the VPRC/VPRH provides years of quiet comfort.

In addition to the application benefits, RetroAire's engineers have included several design features to further lower the sound of the unit.

Dynamically balanced indoor fan reduces indoor vibration and noise.

Compressor isolating grommets reduce transmitted vibration and noise to the chassis.

Reliable Service

RETROAIRE
The Right Fit for Comfort

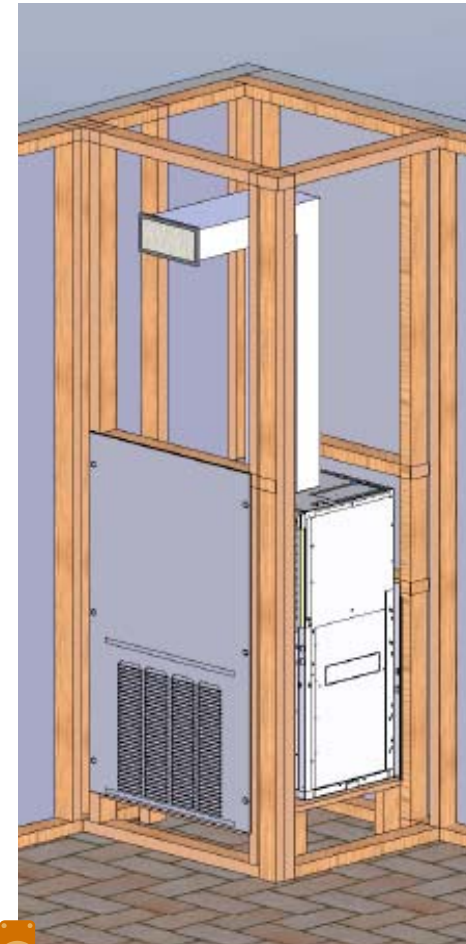

 **ecr**
innovative living™

VPRC/VPRH

Single Packaged Vertical Unit

Control Features

Common control board for both Straight Cool and Heat Pump units

Compatible with most commercial thermostats.

Clear diagnostic LED codes for easy troubleshooting.

Test feature allows for quick start testing of newly installed units.

Emergency Heat available on Heat Pumps with a 2-stage thermostat.

Random Start Timer prevents multiple units from starting together.

Anti-short Cycle Timer aids in compressor reliability.

Reliable Service

RETROAIRE
The Right Fit for Comfort

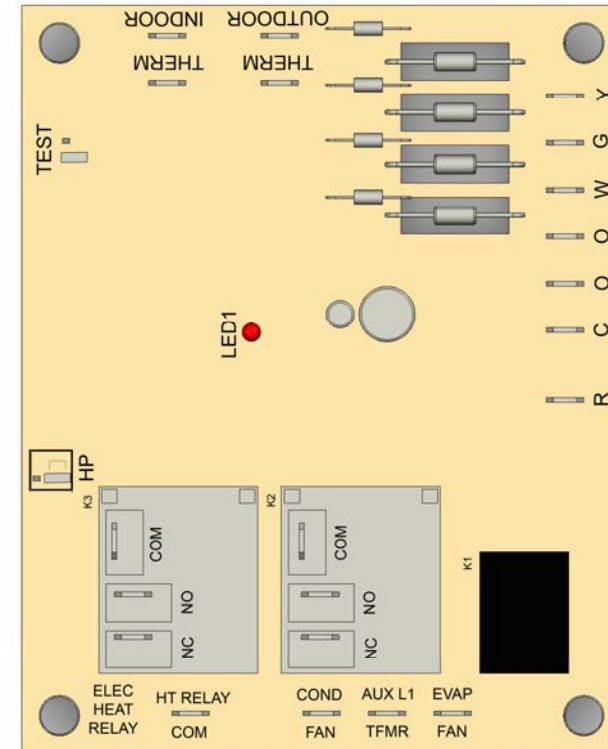

 **ecr**
innovative living™

VPRC/VPRH

Single Packaged Vertical Unit

Peace of Mind

Factory Testing of each unit insures an easy start-up. All units are functionally tested on the production line.

Random Quality Audits of production units ensure quality standards are maintained.

The VPRC/VPRH units are designed and produced in an ISO 9000 Certified facility.

Reliable Service

RETROAIRE
The Right Fit for Comfort



VPRC/VPRH

Single Packaged Vertical Unit

Standard Features

Anodized Aluminum Outdoor Louver
(Custom Colors are available)

Heavy Gauge, Custom Depth Wall Sleeve

Heavy Gauge, Powder Coat Painted Base
with overflow protection.

Fresh Air Vent

Return Air Filter

Field Convertible Control Box Location
(VPRC/VPRH09-24 Only)

Field Convertible Drain Stub Location
(VPRC/VPRH09-24 Only)

Value and Versatility

RETROAIRE
The Right Fit for Comfort

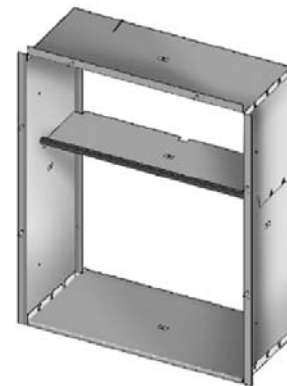

Custom Wall Sleeve



Outdoor Louver

VPRC/VPRH

Single Packaged Vertical Unit

RETROAIRE
The Right Fit for Comfort

Factory Installed Options

Electric Heat

Unit	Available Electric Heat, kW (230 V)						
	2	3	4	5	7	10	15
09	X	X	X	X			
12	X	X	X	X			
18	X	X	X	X			
19		X	X	X	X	X	
24		X	X	X	X	X	
30				X	X	X	
36				X	X	X	X

Hydronic Heat (09-24 Only)

- Sweat Connections
- 24 V Hydronic Control Valve
- Optional Ball Valves
- Optional P/T Ports
- Optional Auto Balancing Valves

Value and Versatility



Electric Heat Module
(VPR_12 Shown)

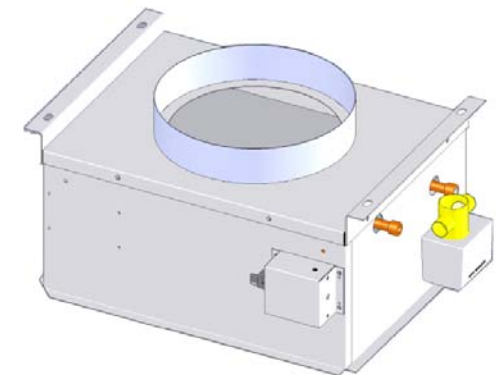

Hydronic Heat
Module
(VPR_12 Shown)

VPRC/VPRH

Single Packaged Vertical Unit

RETROAIRE
The Right Fit for Comfort

Factory Installed Options

Control Box Location - Front, Left or Right
(09-24 Only)

Electrical Disconnect (with up to 5 kW
Electric Heat)

Coated Condenser Coils for Corrosion
Protection

10" Round Duct Collar (09-18 Only)

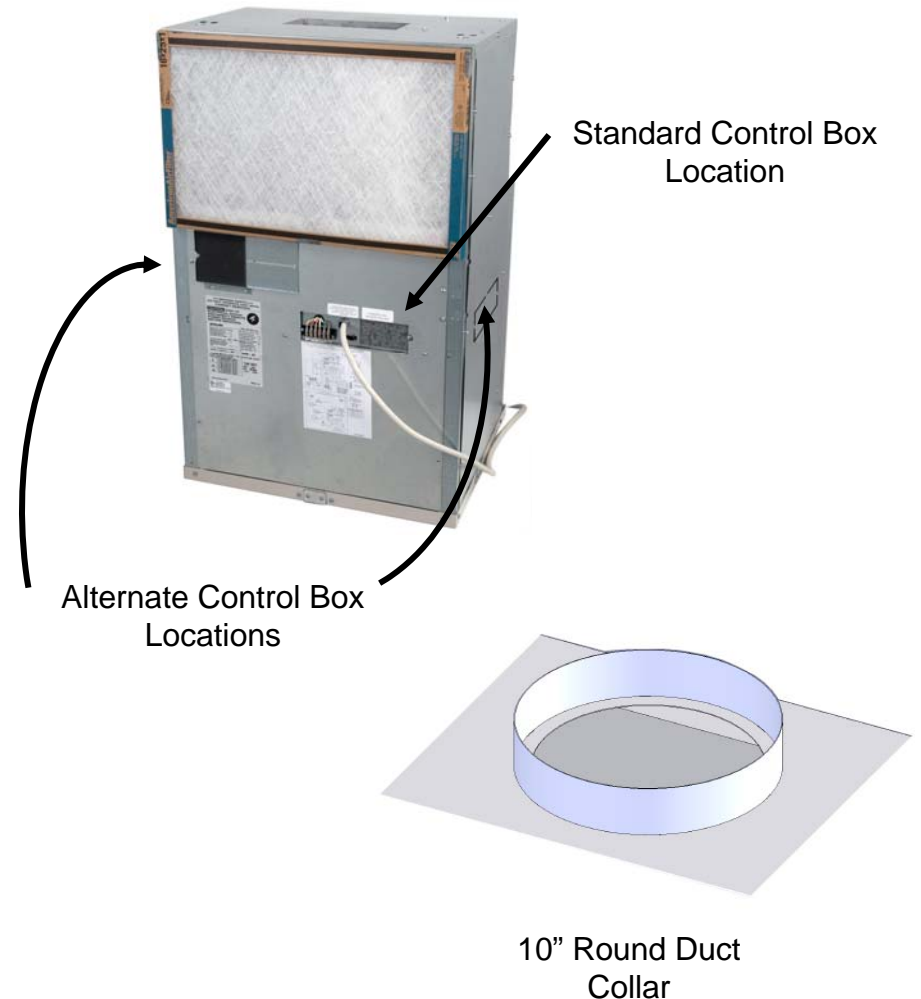

Value and Versatility

VPRC/VPRH

Single Packaged Vertical Unit

Field Installed Accessories

Return Air/Access Panel

- Louvered Panel with Filter Rack and Disposable Filter
- Non-Louvered Panel for Ducted Returns

Digital Thermostats

- Single Stage, MCO
- 2-Stage, MCO

10" Round Duct Collar (09-18 Only)

Drain Stub Assembly (09-12, 19-24 Only)

Value and Versatility

RETROAIRE
The Right Fit for Comfort

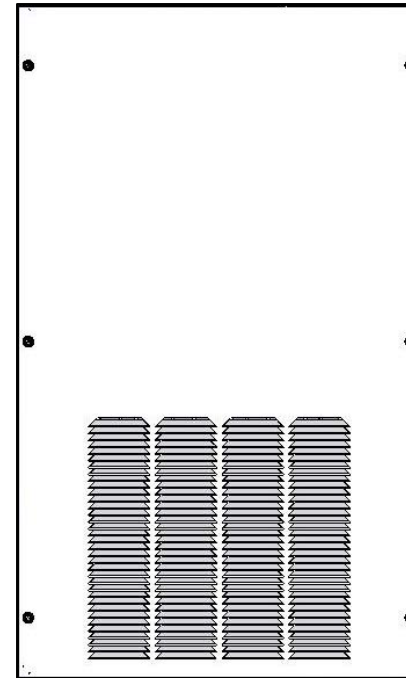

Return Air Access Panel



Wall Thermostat

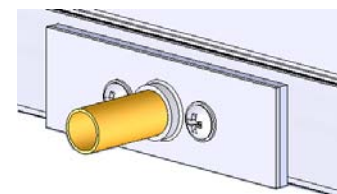

Drain Stub Assembly

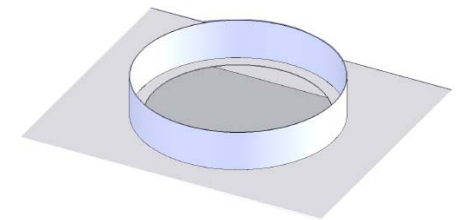

10" Round Duct Collar

VPRC/VPRH

Single Packaged Vertical Unit

Whatever your motivating factor...

Value

Environmental Protection

Versatility

Reliability

RetroAire's VPRC/VPRH units are
"The Right Fit for Comfort"

RETROAIRE
The Right Fit for Comfort



 **ecr**
innovative living™