

Job Name: \_\_\_\_\_ Location: \_\_\_\_\_  
 Customer: \_\_\_\_\_  
 Project Engineer: \_\_\_\_\_  
 Project Architect: \_\_\_\_\_  
 General Contractor: \_\_\_\_\_  
 Submitted By: \_\_\_\_\_ Date: \_\_\_\_\_ For: Reference [ ] Approval [ ]

**ENGINEERING SUBMITTAL**

### STANDARD FEATURES

The standard VPAC/VPHP unit comes equipped with the following:

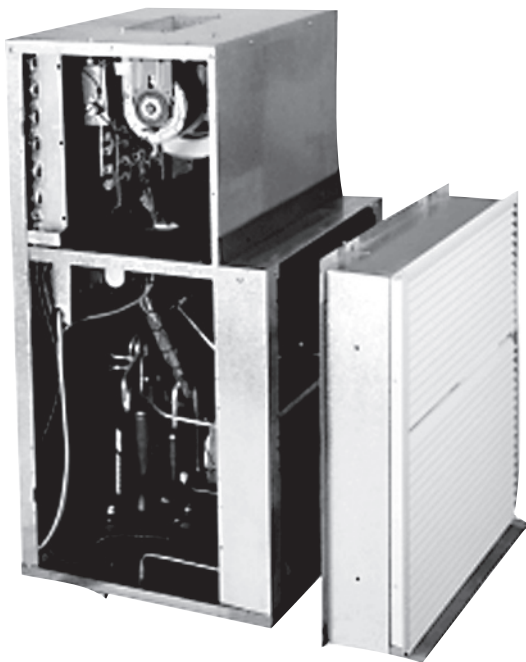

- No internal drain necessary – slinger ring for positive condensate re-evaporation
- Dual motors for reduced sound levels
- Plug connection at the control box (right, left or front mounted) for use with a 24 Volt thermostat
- 208/230 Volt line cord - on models up to 5 kW heat (7 and 10 kW heat applications are hard wired, see specifications on page 2. All 265V applications are also hard wired)
- Manual fresh air damper
- Custom wall sleeve
- Indoor/outdoor mounting anodized outdoor louver for field installation (optional colors available)
- Supplemental electric heat
- Heat Pump (VPHP) limited range heat pumps w/HP operation to 40° F
- Universal Microprocessor Board Features include:
  - Fan purge
  - Anti-short cycle protection
  - Random start timer
  - Freeze protection
  - Low ambient lockout
  - Test operation

*If other than the standard features listed above are needed, **customize** your application by choosing from the following options.*

OPTIONS	X	OPTIONS	X
• Hydronic Heat Package - consult factory		• Return Air Access Panel with Frame and Filter	
• 265/277 Volt (Hard Wired)		• Painted Condenser Louver (specify color)	
• Casters - for ease of service and maneuverability		• Remote Thermostat - Mercury Bulb or Digital	
• Disconnect Switch (units up to 7 kW electric heat only)		• Internal Drain connection If Necessary (in either left, center or right location)	
• Energy Management System (EMS) Relay			



# Engineering Submittal and Wall Sleeve Specification Worksheet

## VPAC/VPHP Single Package Vertical Air Conditioner/Heat Pump

9,000 - 12,000 - 15,000 - 17,000 - 19,000 - 24,000 Btuh

240007064 Rev. 1.7 [01/08]

**Important Note:** You must circle or mark the specifications for:  
 • Capacity • Straight Cool or Heat Pump • Voltage • Electric Heat or Hydronic Heat

Model	Btuh		Efficiency		Electric Heat				Max. HACR Breaker		No Electric Heat	Hydrocoil					Dimensions			Weight (lbs.)			
	Cooling VPAC/VPHP	Heating VPHP	EER VPAC/VPHP	COP (VPHP)	Heater Size	Volts	Btuh	Amps	Line Cord	Electric Heat	No Electric Heat	Line Cord	CFM	GFM	H <sub>2</sub> O Temp	Btuh	PD (Ft/H <sub>2</sub> O)	Width (in.)	Height (in.)		Depth (in.)		
																					VPHP	VPAC	
9	8,700 8,800	8,800	8.7 8.7	2.8	3kw	208	8,400	11.8	6-20P	20	15	6-15P	300	1	180	11,100	1.0	25"	40"	21.4"	20"	140	
						230	10,300	13.0		20													
						265	12,900	14.2		H-Wire													20
					4kw	208	11,200	15.7	6-30P	25													
						230	13,700	17.4		25													
						265	18,200	20.0		H-Wire													30
	5kw	208	14,000	19.7	6-30P	30																	
		230	17,100	21.7		30																	
		208	14,000	19.7		30																	
	12	11,500 11,500	11,500	8.8 8.8	3.1	3kw	208	8,400	11.8	6-20P	20	15	6-15P	300	1	180	11,500	1.0	25"	40"	21.4"	20"	140
							230	10,300	13.0		20												
							265	12,900	14.2		H-Wire												
4kw						208	11,200	15.7	6-30P	25													
						230	13,700	17.4		25													
						265	18,200	20.0		H-Wire	30												
5kw		208	14,000	19.7	6-30P	30																	
		230	17,100	21.7		30																	
		208	14,000	19.7		30																	
15		15,600 15,000	15,000	9.0 8.7	3.0	3kw	208	8,400	11.8	6-20P	20	15	6-15P	400	1	180	12,700	1.0	25"	40"	21.4"	20"	140
							230	10,300	13.0		20												
							265	12,900	14.2		H-Wire												
	4kw					208	11,200	15.7	6-30P	25													
						230	13,700	17.4		25													
						265	18,200	20.0		H-Wire	30												
	5kw	208	14,000	19.7	6-30P	30																	
		230	17,100	21.7		30																	
		208	14,000	19.7		30																	
	17	17,000 17,000	17,000	8.3 8.3	2.7	3kw	208	8,400	11.8	6-20P	20	15	6-15P	500	2	160	24,115	0.9	25"	40"	21.4"	20"	250
							230	10,300	13.0		20												
							265	12,900	14.2		H-Wire												
4kw						208	11,200	15.7	6-30P	25													
						230	13,700	17.4		25													
						265	18,200	20.0		H-Wire	30												
5kw		208	14,000	19.7	6-30P	30																	
		230	17,100	21.7		30																	
		208	14,000	19.7		30																	
19		18,500 18,500	18,000	9.5 9.5	3.0	3kw	208	8,400	11.8	6-20P	20	15	6-15P	500	2	180	29,740	0.9	25"	50"	21.4"	20"	250
							230	10,300	13.0		20												
							265	12,900	14.2		H-Wire												
	4kw					208	11,200	15.7	6-30P	25													
						230	13,700	17.4		25													
						265	18,200	20.0		H-Wire	30												
	5kw	208	14,000	19.7	6-30P	30																	
		230	17,100	21.7		30																	
		208	14,000	19.7		30																	
	7kw	208	19,600	27.5	H-Wire	40																	
		230	23,900	30.4		40																	
		208	19,600	27.5		40																	
24	23,200 22,600	20,000	9.0 9.0	2.7	3kw	208	8,400	11.8	6-20P	20	20	6-20P	650	2	160	29,800	0.9	25"	50"	26.4"	25"	250	
						230	10,300	13.0		20													
						265	12,900	14.2		H-Wire													25
					4kw	208	11,200	15.7	6-30P	25													
						230	13,700	17.4		25													
						265	18,200	20.0		H-Wire													30
	5kw	208	14,000	19.7	6-30P	30																	
		230	17,100	21.7		30																	
		265	22,700	25.0		35																	
	7kw	208	19,600	27.5	H-Wire	40																	
		230	23,900	30.4		40																	
		208	19,600	27.5		40																	
	10kw	208	28,000	39.3	H-Wire	60																	
		230	34,200	43.5		60																	
		208	28,000	39.3		60																	

Performance data is subject to change without notice. For the most current unit/system performance data, please refer to the Enviromaster International listing of certified products in the ARI directory, at [www.aridirectory.org](http://www.aridirectory.org).



Engineering Submittal and Wall Sleeve Specification Worksheet
VPAC/VPHP Single Package Vertical Air Conditioner/Heat Pump
9,000 - 12,000 - 15,000 - 17,000 - 19,000 - 24,000 Btuh

240007064 Rev. 1.7 [01/08]

VPAC/VPHP ORDER SPECIFICATIONS FOR ENGINEERING PURPOSES

This is very important information to make certain that equipment supplied is properly designed for the application for which it was intended.

1. TYPE OF CONSTRUCTION: New Construction [ ] Replacement [ ]
If replacement, what is the current model being replaced?
Manufacturer Model #

2. TYPE OF APPLICATION: Hotel/Motel [ ] Office [ ] Suites [ ] Condo [ ] Apartments [ ]
Other (Please explain)
How many rooms are being conditioned by one unit?

3. ELECTRIC HEAT: Output or kW: Current Circuit Breaker Used: amps

4. FIELD SUPPLY VOLTAGE: 208/230 265/277

5. IS THERE AN INTERNAL DRAIN SYSTEM FOR CONDENSATE REMOVAL? Yes [ ] No [ ]
If Yes, will the customer need an overflow stub in the base or to extend the drain hose?
Location of drain stub: Front [ ] Left Side [ ] Right Side [ ]

6. WHAT ARE THE PLANNED DIMENSIONS OF THE UNIT ENCLOSURE? L W H
(NOTE: Unit enclosure must meet minimum clearance specifications.)

7. IS ACCESS/RETURN AIR PANEL TO BE SUPPLIED? Yes [ ] No [ ]
(NOTE: Standard R/A Access Panel is supplied with a 1. disposable filter.)
If not, what will be used?
What is return air opening size? L W
What is free area of existing return air opening?

Attach sketch or photo if possible.

8. WHAT CONTROL ACCESS IS REQUIRED WHEN LOOKING AT FRONT OF UNIT (Indoor Coil Side)?
Left Side [ ] Ride Side [ ] Front [ ]

9. WHAT IS DESIGNED EXTERNAL STATIC PRESSURE (E.S.P.)?
If not known, describe the supply air configuration.
Rectangular Duct L W
Circular Duct Diameter Duct Length
How many supply air diffusers?

(NOTE: Standard louver color is anodized aluminum. If special color is requested, please note there is an additional charge for special color louvers.)

**IMPORTANT:** The total wall depth must be a minimum of 5.25" for straight cool (VPAC) units and 6.5" for heat pump (VPHP) units. If these dimensions cannot be met, the wall sleeve will protrude into the closet/enclosure and may require additional finish work.

### WALL SLEEVE DEPTH INFORMATION:

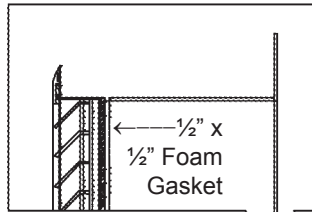

Fill In Your Information Here:

Overall Wall Thickness \_\_\_\_\_

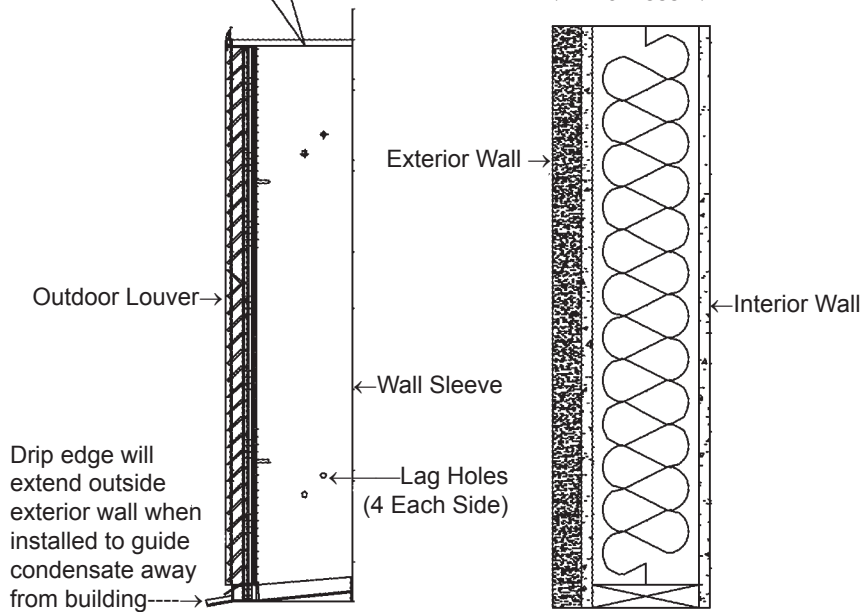

Wall Sleeve Assembly

Cross Section of a Typical Wall



Tested/Rated In  
Accordance With ARI  
Standard 390



Company Name \_\_\_\_\_

Authorized Signature \_\_\_\_\_

Date \_\_\_\_\_

EMI Signature \_\_\_\_\_

Date \_\_\_\_\_